

BAG TRANSFER

FOR TRANSFERRING THE BAGS FROM THE CLOSING CONVEYOR TO PALLETISING

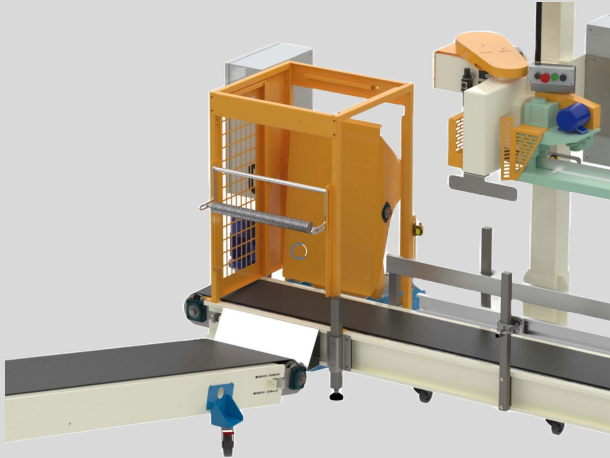

Packweigh Bag Transfer Solutions

Optimized Bag Handling for Seamless Palletising

Packweigh offers a variety of bag transfer solutions designed to ensure smooth movement from the bag closing conveyor to the palletising system, whether for manual or automatic palletising.

Transfer Options

90-Degree Kicker – Ideal for efficient layouts.

- Available in top-first or bottom-first configurations to present bags optimally for palletising.

Inline Turner – Designed for where a narrow layout is required.

- Top grip mechanism turns the bag for controlled placement.

- Optional gripper lowering feature ensures ideal positioning for automatic palletising. For superior pallet presentation

- Knock down lowering and turning offers a cost effective solution for lower speed lines

With **Packweigh bag transfer systems**, bags are presented for high-quality stacking, improving efficiency and ensuring a consistent pallet structure.

Talk to Packweigh today to find the best solution for your requirements

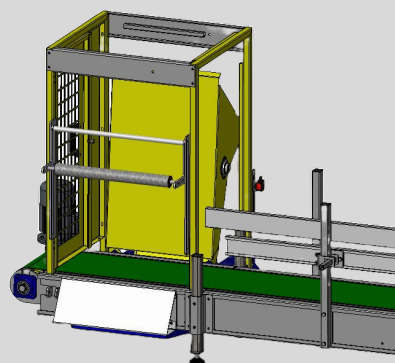
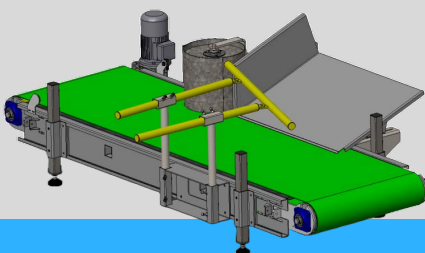
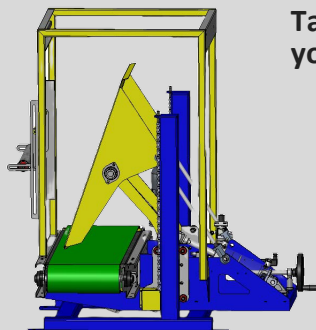
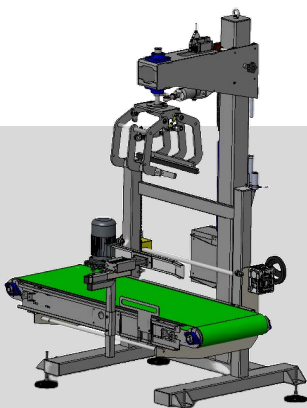
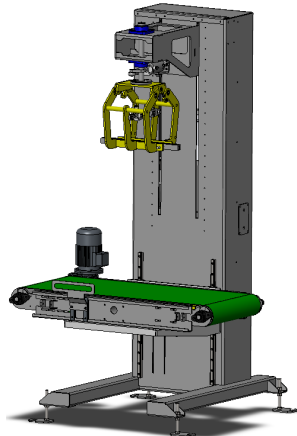
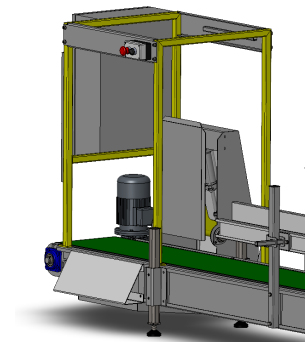

Packweigh Equipment

www.packweigh.com.au | sales@packweigh.com.au

Ph 07 38231033 | 21 Hook St Capalaba, QLD, 4157

